

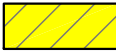

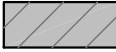









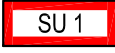

LEGEND

LOCAL SCHEME RESERVES



-  PUBLIC PURPOSES
-  RAILWAYS
-  PUBLIC OPEN SPACE
-  PRIMARY DISTRIBUTOR ROAD
-  LOCAL ROAD



ZONES

-  RESIDENTIAL
-  COMMERCIAL
-  SPECIAL USE (SEE SCHEME TEXT)
-  URBAN DEVELOPMENT
-  ENTERPRISE

-  GENERAL INDUSTRY
-  INDUSTRIAL DEVELOPMENT
-  RURAL
-  RURAL RESIDENTIAL (SEE SCHEME TEXT)
-  RURAL SMALLHOLDINGS

OTHER

-  R CODES
-  ADDITIONAL USES
-  SPECIAL CONTROL AREA - INFRASTRUCTURE

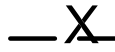
-  SCHEME BOUNDARY
-  LOCAL GOVERNMENT BOUNDARY
-  TOWNSITE - LAND ACT

Produced by the planning department of the Shire of Katanning.
Drafting by John de Snoo

Whilst every care has been taken to accurately portray the current Scheme provisions, no responsibility shall be taken for any errors or omissions in this documentation.

Consultation with the Shire of Katanning should be made to view a legal version of the Scheme.
Please advise the Department of Planning of any errors or omissions in this document.

Base on cadastral data supplied by Landgate.

Authorised :

Plot Date:

G.Gazette:

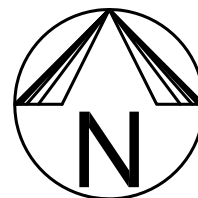

MAP KEY

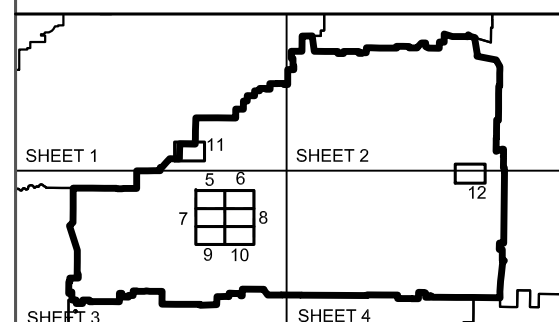

SHIRE OF KATANNING
LOCAL PLANNING SCHEME No. 5
DISTRICT SCHEME

SCHEME MAP LEGEND

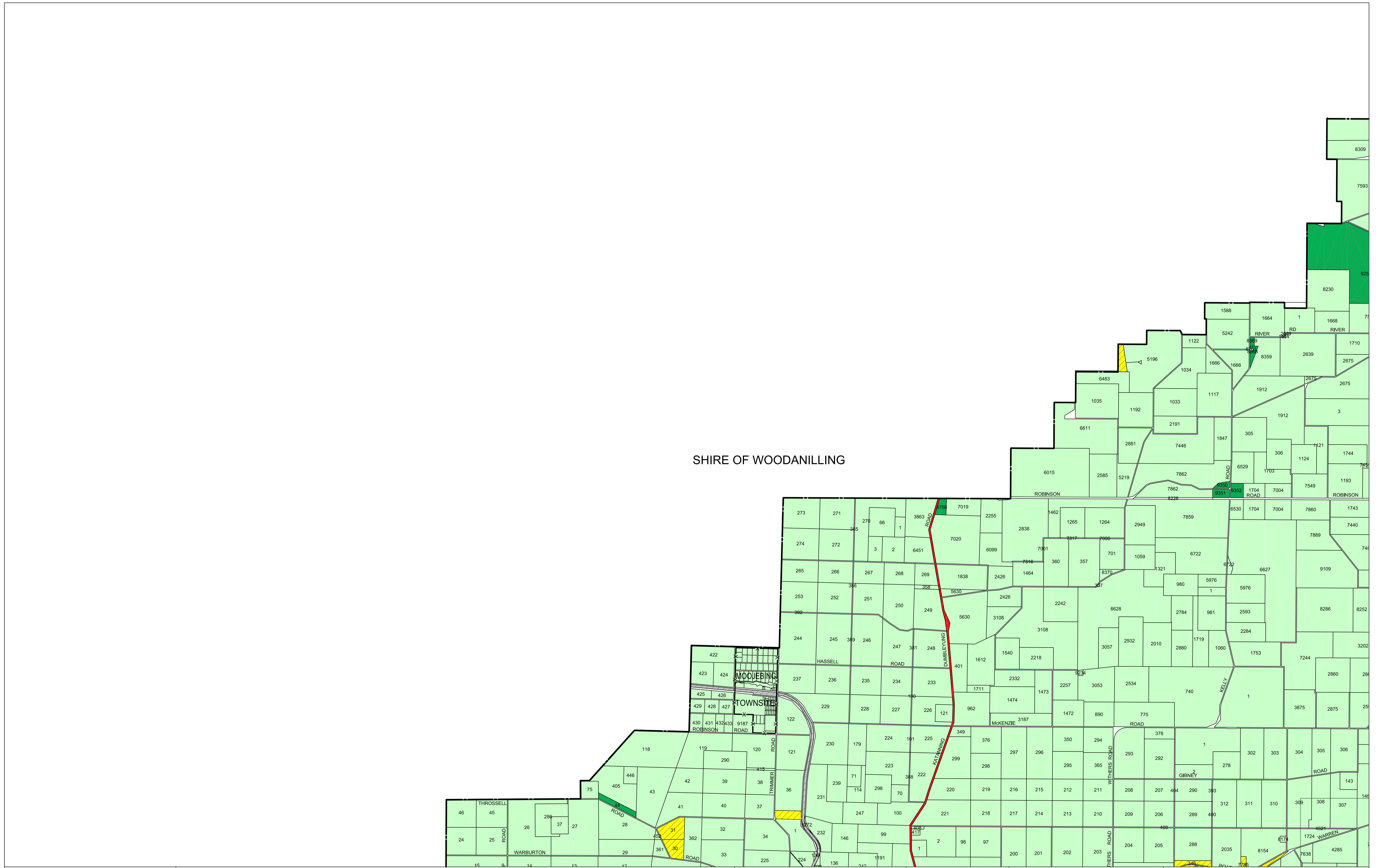

Produced by the planning department of the Shire of Katanning.
 Drafting by John de Snoo

Whilst every care has been taken to accurately portray the current Scheme provisions, no responsibility shall be taken for any errors or omissions in this documentation.

Consultation with the Shire of Katanning should be made to view a legal version of the Scheme.
 Please advise the Department of Planning of any errors or omissions in this document.

Base on cadastral data supplied by Landgate.

LEGEND		ZONES		OTHER	
PUBLIC PURPOSES	RESIDENTIAL	GENERAL INDUSTRY	R 30 R CODES	SCHEME BOUNDARY	A1 ADDITIONAL USES
RAILWAYS	COMMERCIAL	INDUSTRIAL DEVELOPMENT	A1 ADDITIONAL USES	LOCAL GOVERNMENT BOUNDARY	SCA SPECIAL CONTROL AREA - INFRASTRUCTURE
PUBLIC OPEN SPACE	SU 1 SPECIAL USE (SEE SCHEME TEXT)	RURAL	TOWNSITE - LAND ACT		
PRIMARY DISTRIBUTOR ROAD	URBAN DEVELOPMENT	RR 1 RURAL RESIDENTIAL (SEE SCHEME TEXT)			
LOCAL ROAD	ENTERPRISE	RURAL SMALLHOLDINGS			

Authorised :
 Plot Date:
 G. Gazette:

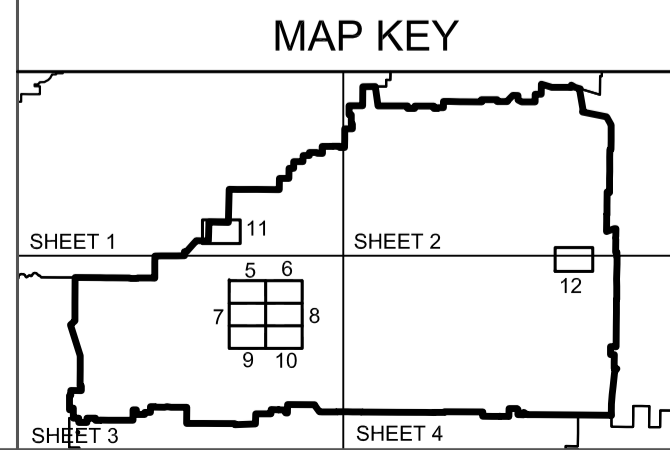
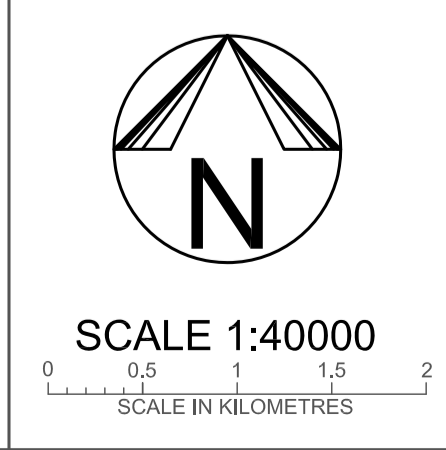

SHIRE OF KATANNING
LOCAL PLANNING SCHEME No. 5
DISTRICT SCHEME

SHEET 1 of 12

THIS IS A CAD DRAWING DO NOT AMEND MANUALLY

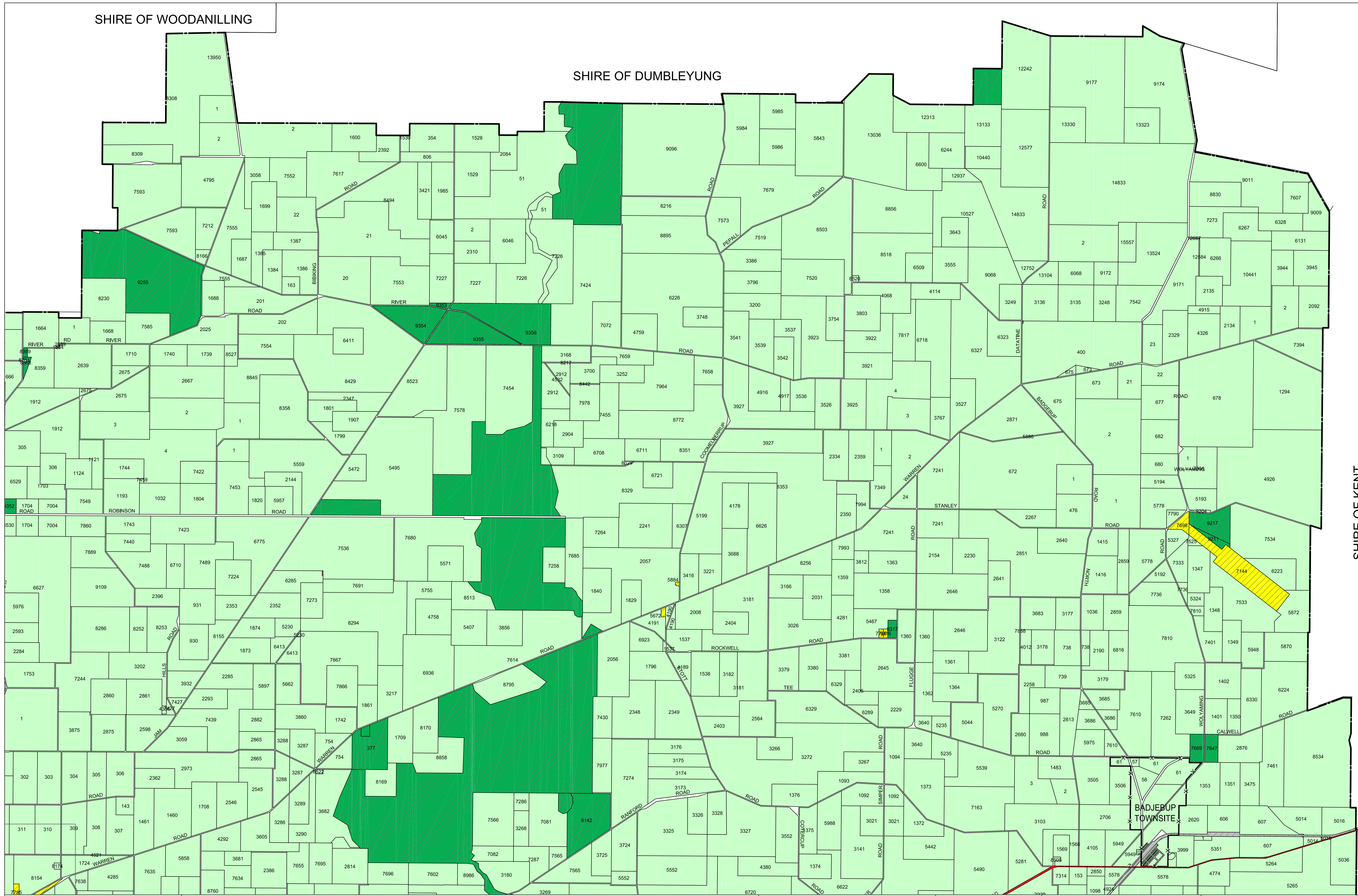

Produced by the planning department of the Shire of Katanning.
 Drafting by John de Snoo

Whilst every care has been taken to accurately portray the current Scheme provisions, no responsibility shall be taken for any errors or omissions in this documentation.

Consultation with the Shire of Katanning should be made to view a legal version of the Scheme.
 Please advise the Department of Planning of any errors or omissions in this document.

Base on cadastral data supplied by Landgate.

LEGEND

PUBLIC PURPOSES	RESIDENTIAL	GENERAL INDUSTRY	R 30 R CODES	SCHEME BOUNDARY
RAILWAYS	COMMERCIAL	INDUSTRIAL DEVELOPMENT	A 1 ADDITIONAL USES	LOCAL GOVERNMENT BOUNDARY
PUBLIC OPEN SPACE	SU 1 SPECIAL USE (SEE SCHEME TEXT)	RURAL	SCA SPECIAL CONTROL AREA - INFRASTRUCTURE	TOWNSITE - LAND ACT
PRIMARY DISTRIBUTOR ROAD	URBAN DEVELOPMENT	RR 1 RURAL RESIDENTIAL (SEE SCHEME TEXT)		
LOCAL ROAD	ENTERPRISE	RURAL SMALLHOLDINGS		

Authorised :
 Plot Date:
 G.Gazette:

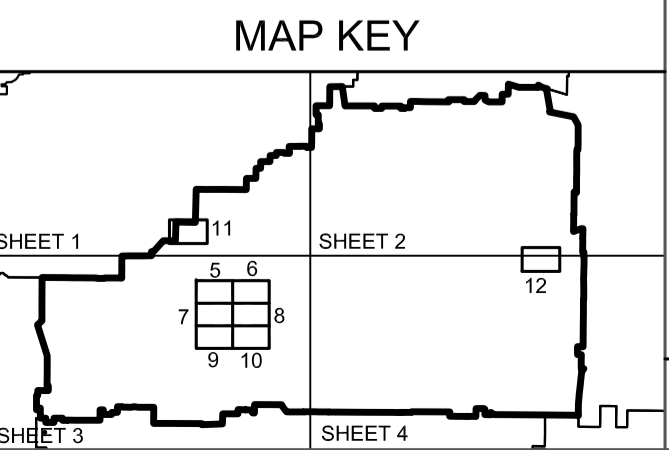
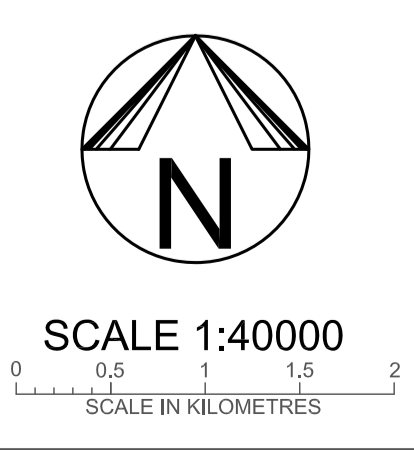

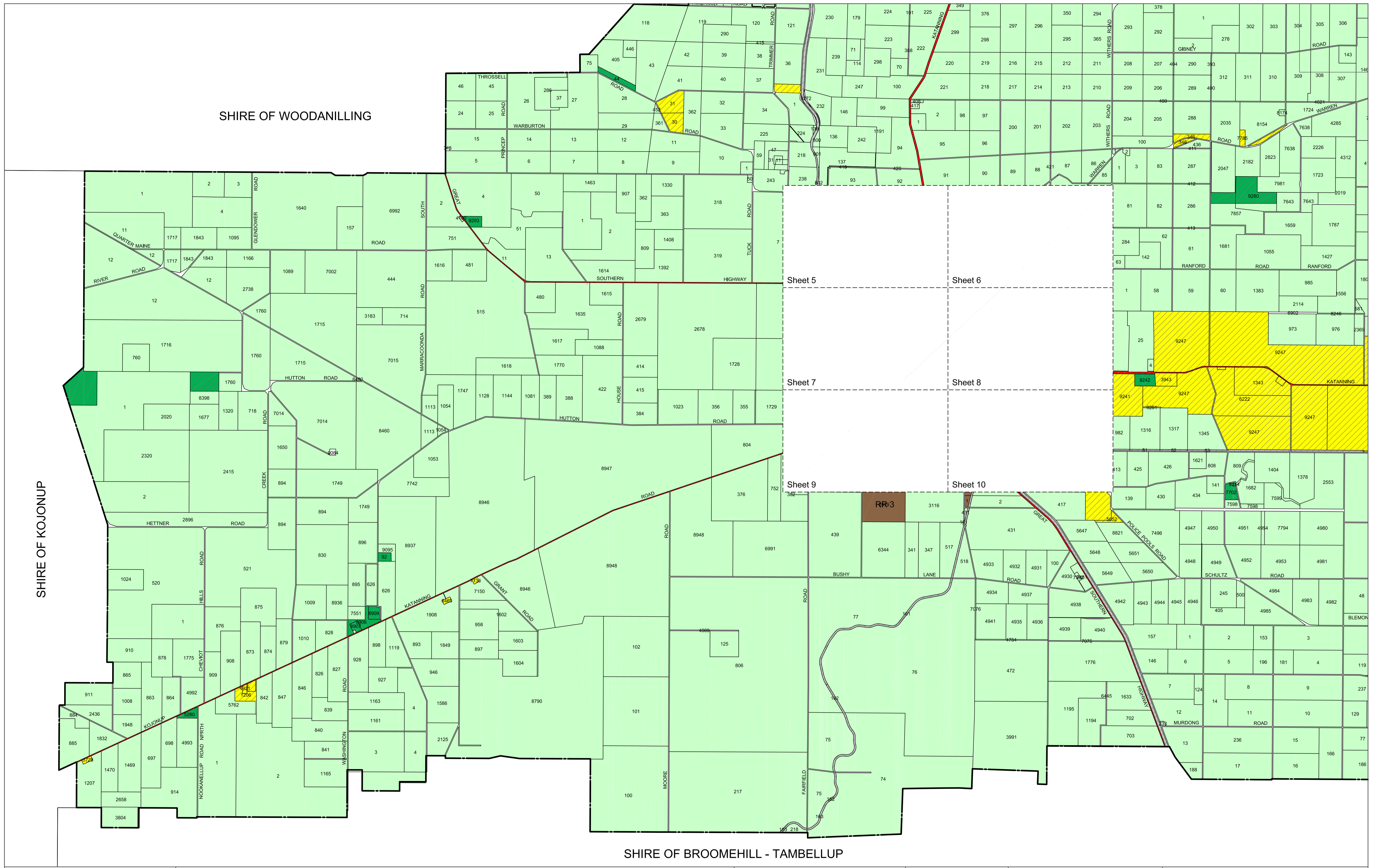

Produced by the planning department of the Shire of Katanning.
 Drafting by John de Snoo

Whilst every care has been taken to accurately portray the current Scheme provisions, no responsibility shall be taken for any errors or omissions in this documentation.

Consultation with the Shire of Katanning should be made to view a legal version of the Scheme.
 Please advise the Department of Planning of any errors or omissions in this document.

Base on cadastral data supplied by Landgate.

LEGEND		ZONES		OTHER	
	PUBLIC PURPOSES		RESIDENTIAL		R CODES
	RAILWAYS		COMMERCIAL		ADDITIONAL USES
	PUBLIC OPEN SPACE		SPECIAL USE (SEE SCHEME TEXT)		SPECIAL CONTROL AREA - INFRASTRUCTURE
	PRIMARY DISTRIBUTOR ROAD		URBAN DEVELOPMENT		RURAL RESIDENTIAL (SEE SCHEME TEXT)
	LOCAL ROAD		ENTERPRISE		RURAL SMALLHOLDINGS
			GENERAL INDUSTRY		SCHEME BOUNDARY
			INDUSTRIAL DEVELOPMENT		LOCAL GOVERNMENT BOUNDARY
			RURAL		TOWNSITE - LAND ACT

Authorised :
 Plot Date:
 G.Gazette:

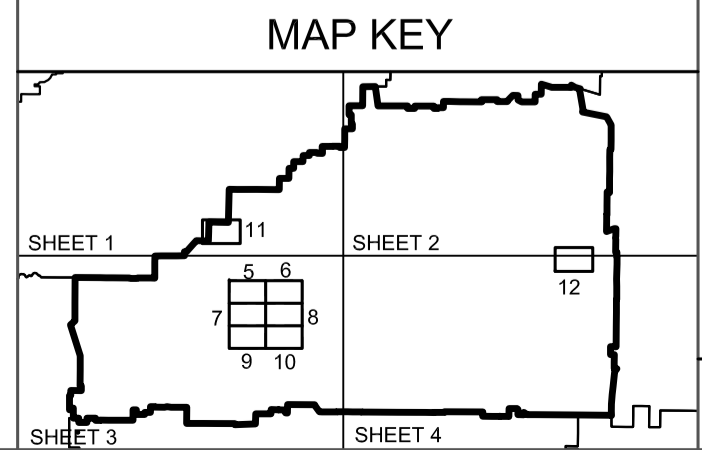
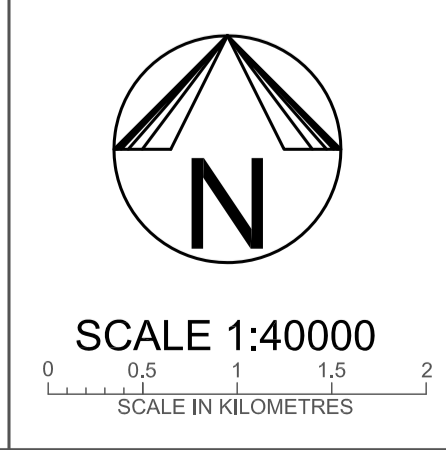

SHIRE OF KATANNING
 LOCAL PLANNING SCHEME No. 5
 DISTRICT SCHEME

SHEET 3 of 12

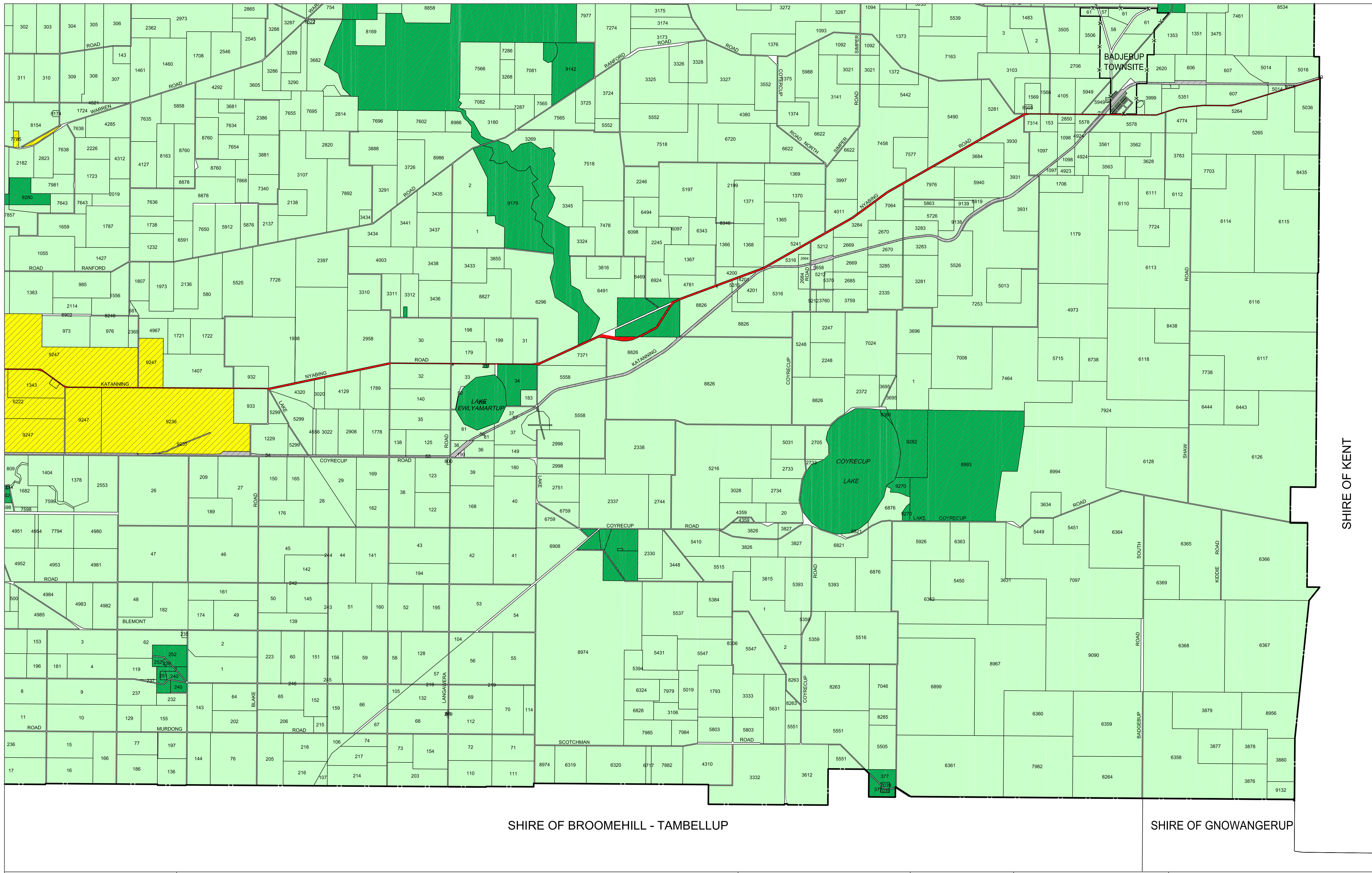

Produced by the planning department of the Shire of Katanning.
Drafting by John de Snoo

Whilst every care has been taken to accurately portray the current Scheme provisions, no responsibility shall be taken for any errors or omissions in this documentation.

Consultation with the Shire of Katanning should be made to view a legal version of the Scheme.
Please advise the Department of Planning of any errors or omissions in this document.

Base on cadastral data supplied by Landgate.

LEGEND		ZONES		OTHER	
	PUBLIC PURPOSES		RESIDENTIAL		GENERAL INDUSTRY
	RAILWAYS		COMMERCIAL		INDUSTRIAL DEVELOPMENT
	PUBLIC OPEN SPACE		SPECIAL USE (SEE SCHEME TEXT)		RURAL
	PRIMARY DISTRIBUTOR ROAD		URBAN DEVELOPMENT		RURAL RESIDENTIAL (SEE SCHEME TEXT)
	LOCAL ROAD		ENTERPRISE		RURAL SMALLHOLDINGS
					R CODES
					ADDITIONAL USES
					SPECIAL CONTROL AREA - INFRASTRUCTURE
					SCHEME BOUNDARY
					LOCAL GOVERNMENT BOUNDARY
					TOWNSITE - LAND ACT

Authorised :
Plot Date:
G.Gazette:

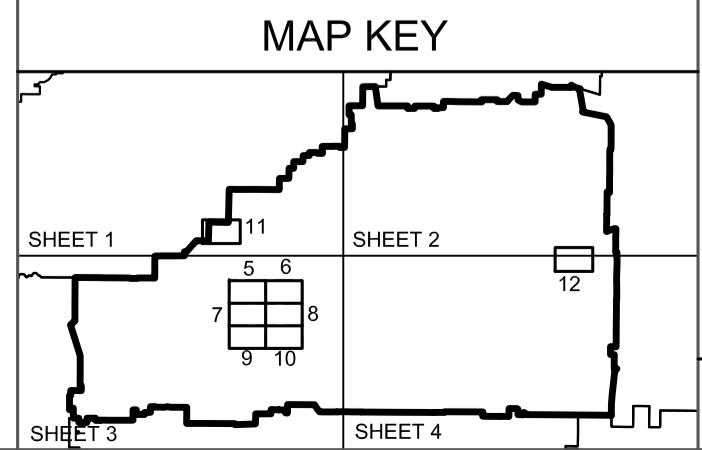
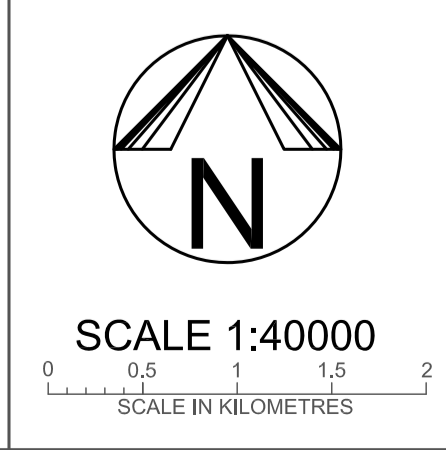

SHIRE OF KATANNING
LOCAL PLANNING SCHEME No. 5
DISTRICT SCHEME

SHEET 4 of 12

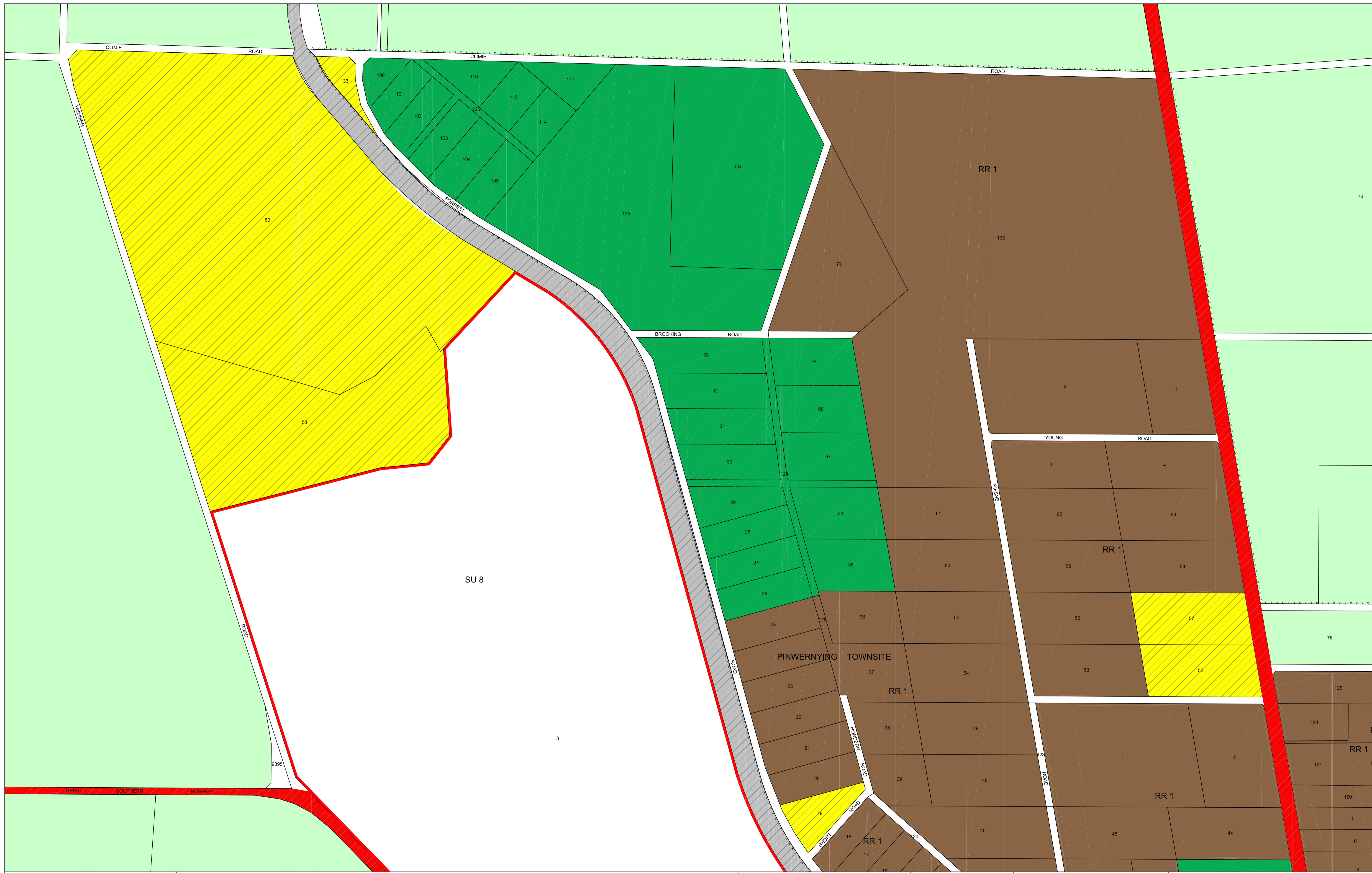

Produced by the planning department of the Shire of Katanning.
 Drafting by John de Snoo

Whilst every care has been taken to accurately portray the current Scheme provisions, no responsibility shall be taken for any errors or omissions in this documentation.

Consultation with the Shire of Katanning should be made to view a legal version of the Scheme.
 Please advise the Department of Planning of any errors or omissions in this document.

Base on cadastral data supplied by Landgate.

LEGEND		LOCAL SCHEME RESERVES		ZONES		OTHER		SCHEME BOUNDARIES	
	PUBLIC PURPOSES		RESIDENTIAL		GENERAL INDUSTRY		R CODES		SCHEME BOUNDARY
	RAILWAYS		COMMERCIAL		SPECIAL USE (SEE SCHEME TEXT)		ADDITIONAL USES		LOCAL GOVERNMENT BOUNDARY
	PUBLIC OPEN SPACE		URBAN DEVELOPMENT		RURAL RESIDENTIAL (SEE SCHEME TEXT)		SPECIAL CONTROL AREA - INFRASTRUCTURE		TOWNSITE - LAND ACT
	PRIMARY DISTRIBUTOR ROAD		ENTERPRISE		RURAL SMALLHOLDINGS				
	LOCAL ROAD								

Authorised :
 Plot Date:
 G.Gazette:

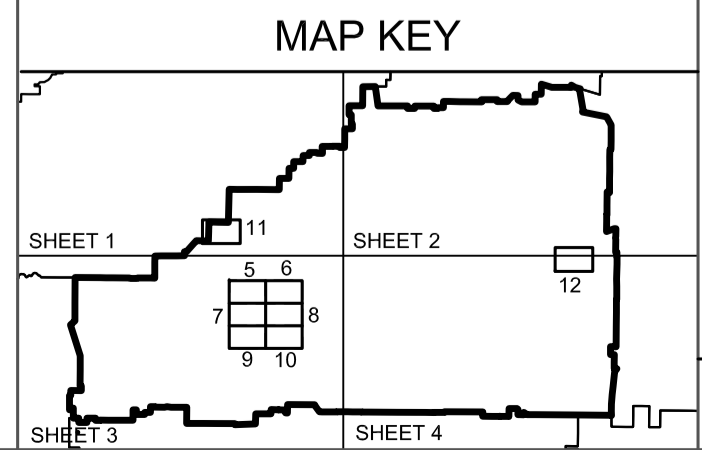
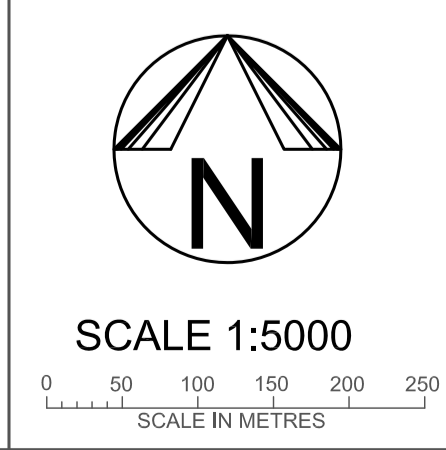

SHIRE OF KATANNING
LOCAL PLANNING SCHEME No. 5
DISTRICT SCHEME

SHEET 5 of 12

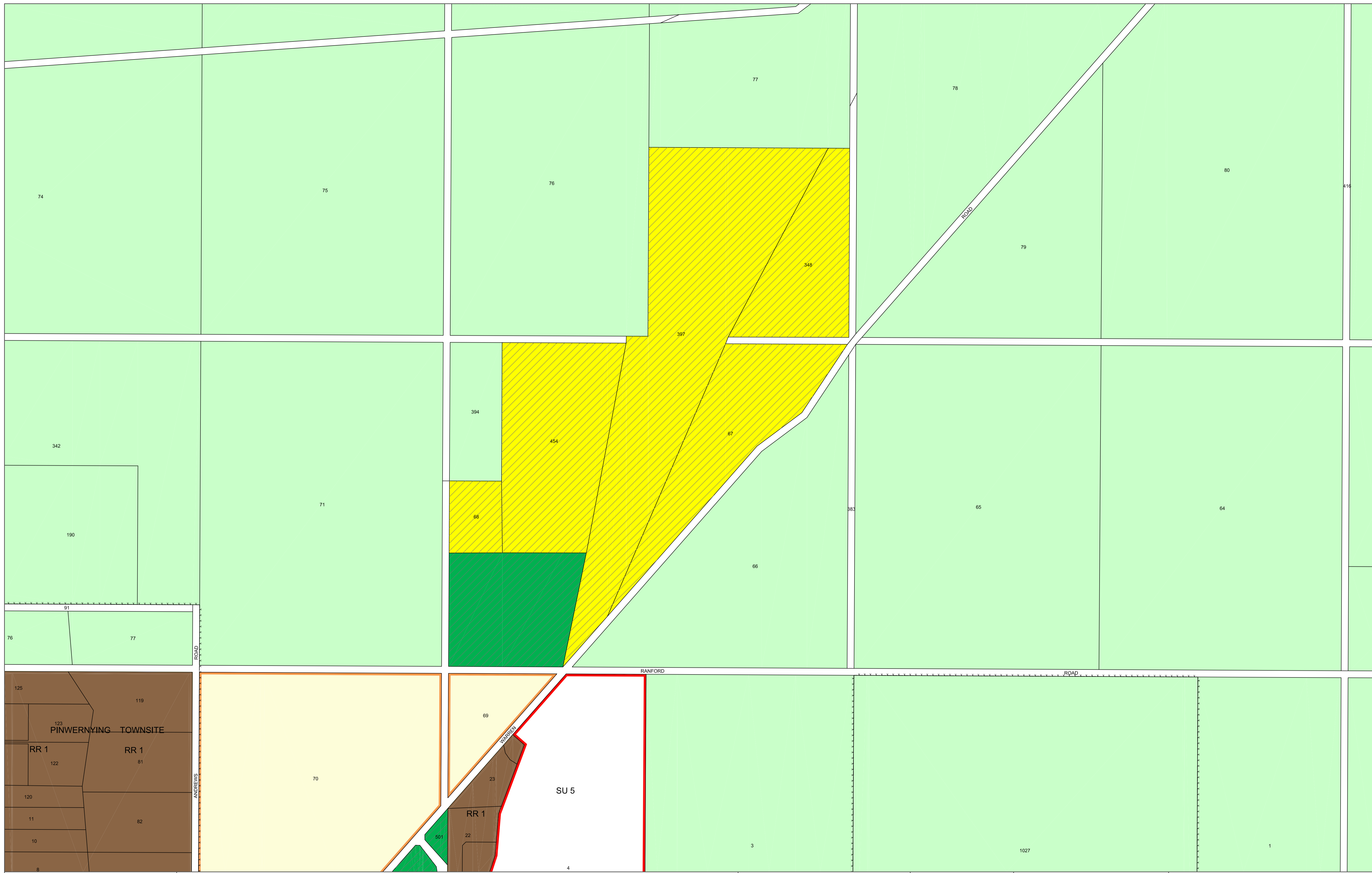

Produced by the planning department of the Shire of Katanning.
 Drafting by John de Snoo

Whilst every care has been taken to accurately portray the current Scheme provisions, no responsibility shall be taken for any errors or omissions in this documentation.

Consultation with the Shire of Katanning should be made to view a legal version of the Scheme.
 Please advise the Department of Planning of any errors or omissions in this document.

Base on cadastral data supplied by Landgate.

LEGEND

PUBLIC PURPOSES	RESIDENTIAL	GENERAL INDUSTRY	R 30 R CODES	SCHEME BOUNDARY
RAILWAYS	COMMERCIAL	INDUSTRIAL DEVELOPMENT	A1 ADDITIONAL USES	LOCAL GOVERNMENT BOUNDARY
PUBLIC OPEN SPACE	SU 1 SPECIAL USE (SEE SCHEME TEXT)	RURAL	SCA SPECIAL CONTROL AREA - INFRASTRUCTURE	TOWNSITE - LAND ACT
PRIMARY DISTRIBUTOR ROAD	URBAN DEVELOPMENT	RR 1 RURAL RESIDENTIAL (SEE SCHEME TEXT)		
LOCAL ROAD	ENTERPRISE	RURAL SMALLHOLDINGS		

Authorised :
 Plot Date:
 G.Gazette:

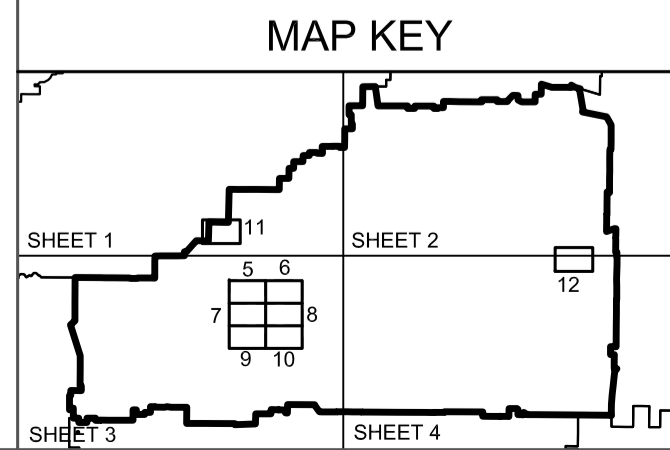
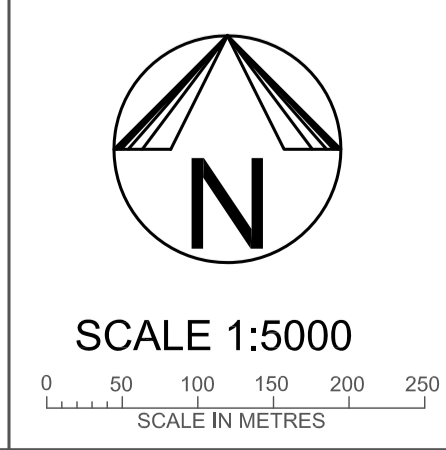

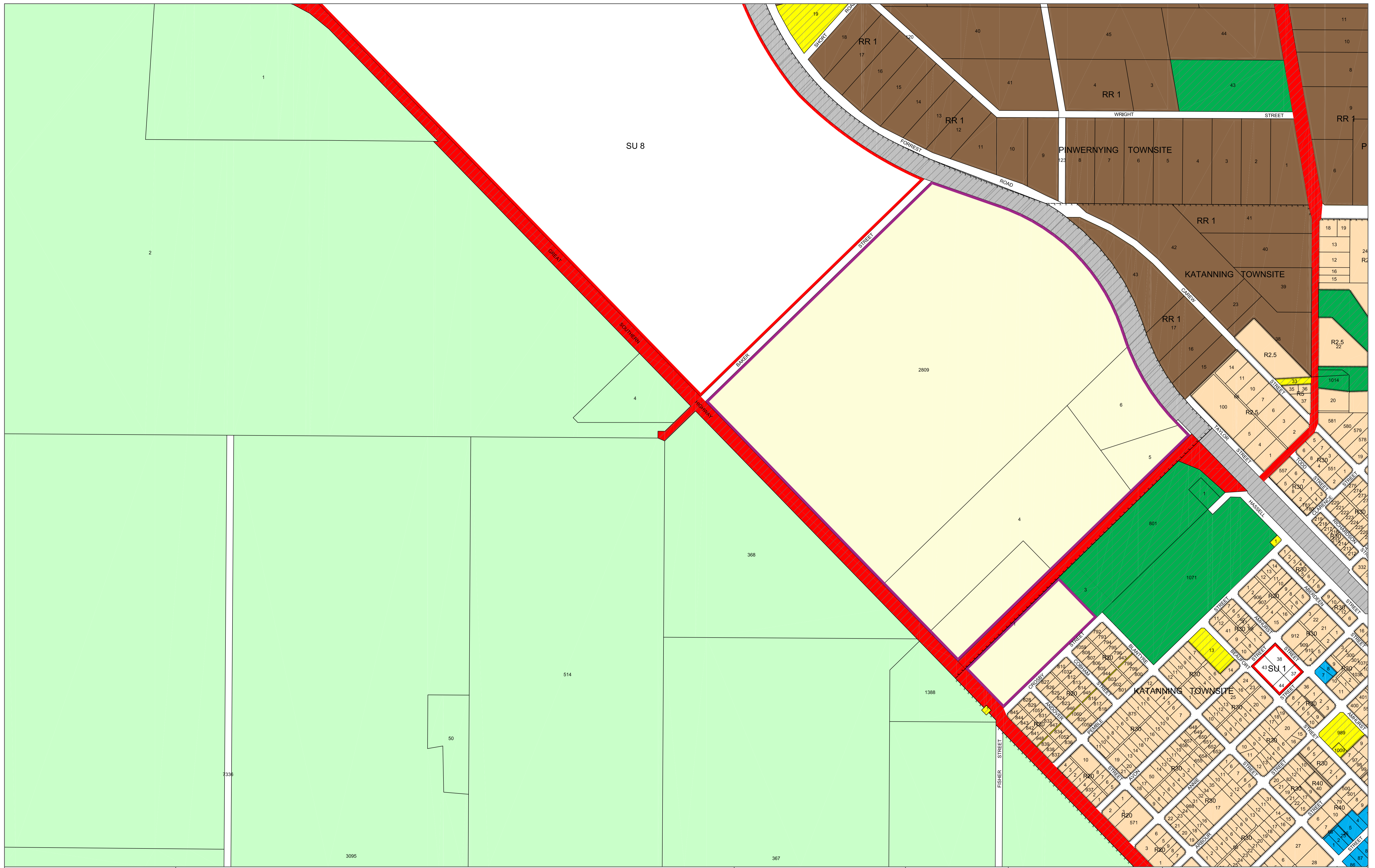

Produced by the planning department of the Shire of Katanning.
 Drafting by John de Snoo

Whilst every care has been taken to accurately portray the current Scheme provisions, no responsibility shall be taken for any errors or omissions in this documentation.

Consultation with the Shire of Katanning should be made to view a legal version of the Scheme.
 Please advise the Department of Planning of any errors or omissions in this document.

Base on cadastral data supplied by Landgate.

LEGEND		OTHER	
PUBLIC PURPOSES	RESIDENTIAL	R 30 R CODES	SCHEME BOUNDARY
RAILWAYS	COMMERCIAL	A 1 ADDITIONAL USES	LOCAL GOVERNMENT BOUNDARY
PUBLIC OPEN SPACE	SU 1 SPECIAL USE (SEE SCHEME TEXT)	SCA SPECIAL CONTROL AREA - INFRASTRUCTURE	TOWNSITE - LAND ACT
PRIMARY DISTRIBUTOR ROAD	URBAN DEVELOPMENT		
LOCAL ROAD	ENTERPRISE		
	GENERAL INDUSTRY		
	INDUSTRIAL DEVELOPMENT		
	RURAL		
	RR 1 RURAL RESIDENTIAL (SEE SCHEME TEXT)		
	RURAL SMALLHOLDINGS		

Authorised :
 Plot Date:
 G.Gazette:

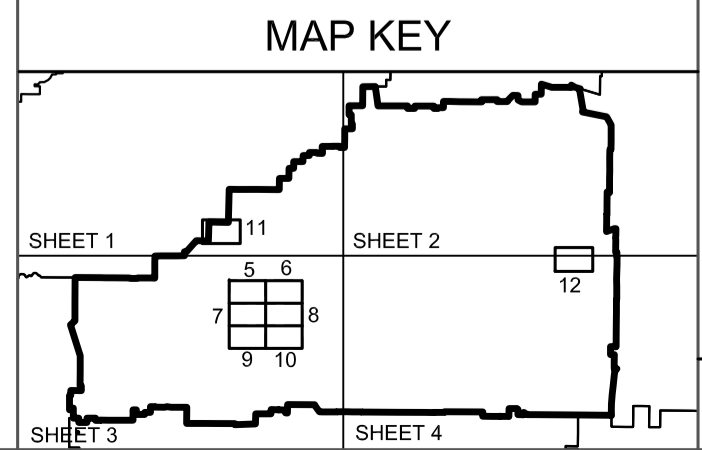
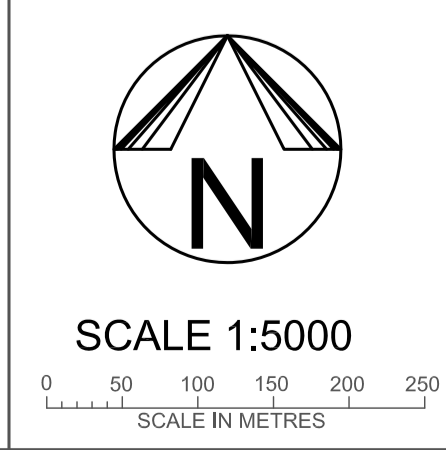

SHIRE OF KATANNING
LOCAL PLANNING SCHEME No. 5
DISTRICT SCHEME

SHEET 7 of 12

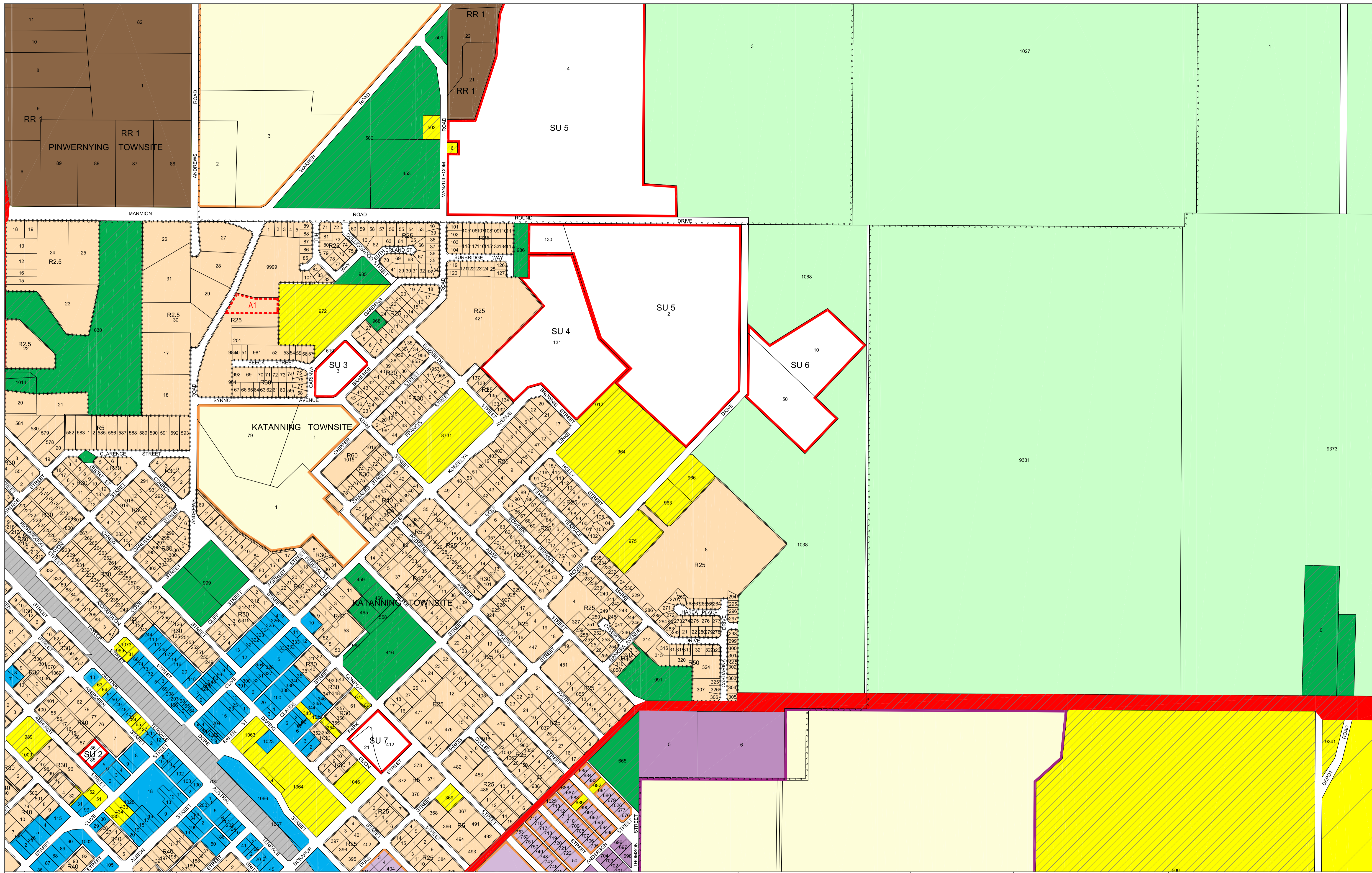

Produced by the planning department of the Shire of Katanning.
 Drafting by John de Snoo

Whilst every care has been taken to accurately portray the current Scheme provisions, no responsibility shall be taken for any errors or omissions in this documentation.

Consultation with the Shire of Katanning should be made to view a legal version of the Scheme.
 Please advise the Department of Planning of any errors or omissions in this document.

Base on cadastral data supplied by Landgate.

LEGEND		OTHER	
LOCAL SCHEME RESERVES	ZONES	R CODES	SCHEME BOUNDARY
PUBLIC PURPOSES	RESIDENTIAL	ADDITIONAL USES	LOCAL GOVERNMENT BOUNDARY
RAILWAYS	COMMERCIAL	SPECIAL CONTROL AREA - INFRASTRUCTURE	TOWNSHIP - LAND ACT
PUBLIC OPEN SPACE	SPECIAL USE (SEE SCHEME TEXT)		
PRIMARY DISTRIBUTOR ROAD	URBAN DEVELOPMENT		
LOCAL ROAD	ENTERPRISE		
	GENERAL INDUSTRY		
	INDUSTRIAL DEVELOPMENT		
	RURAL		
	RURAL RESIDENTIAL (SEE SCHEME TEXT)		
	RURAL SMALLHOLDINGS		

Authorised :
 Plot Date:
 G.Gazette:

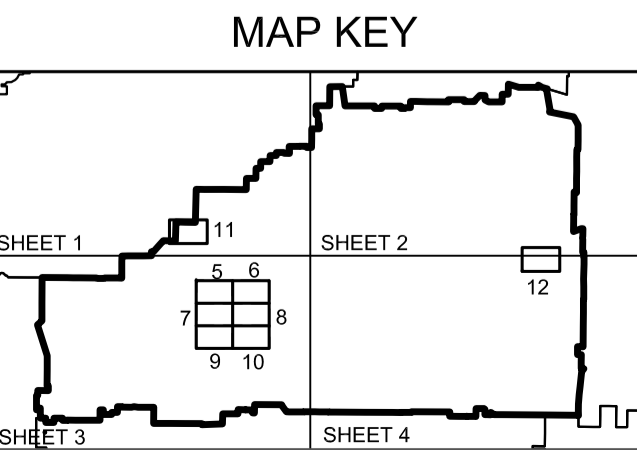
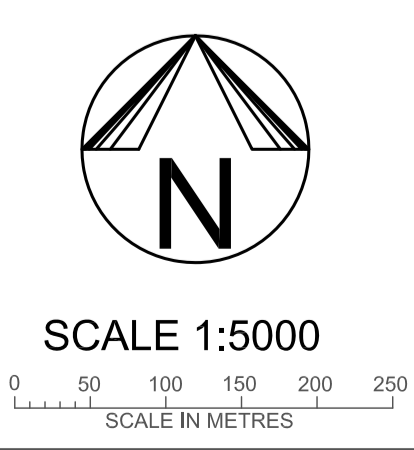

SHIRE OF KATANNING
LOCAL PLANNING SCHEME No. 5
DISTRICT SCHEME

SHEET 8 of 12

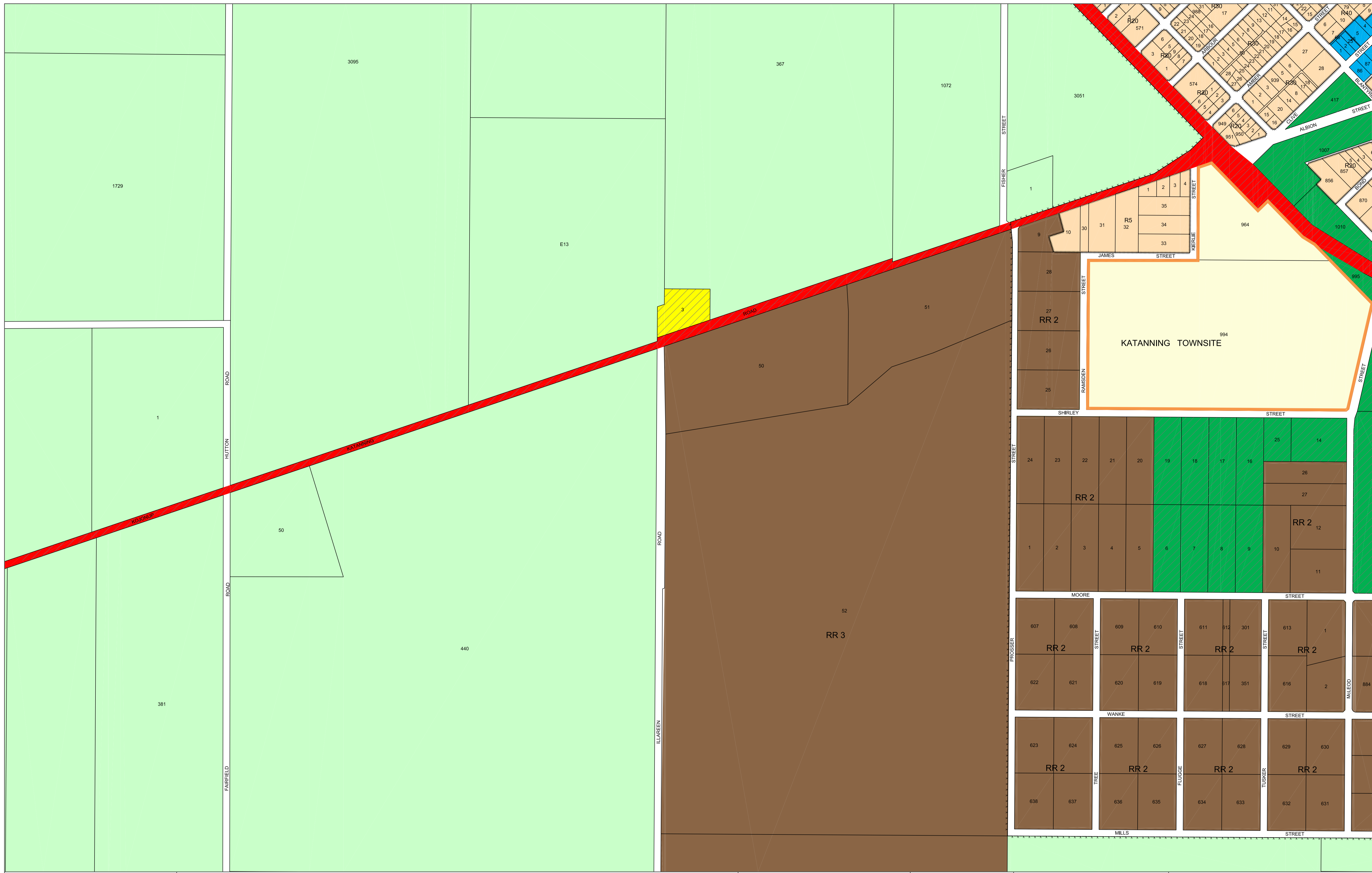

Produced by the planning department of the Shire of Katanning.
 Drafting by John de Snoo

Whilst every care has been taken to accurately portray the current Scheme provisions, no responsibility shall be taken for any errors or omissions in this documentation.

Consultation with the Shire of Katanning should be made to view a legal version of the Scheme.
 Please advise the Department of Planning of any errors or omissions in this document.

Base on cadastral data supplied by Landgate.

LEGEND		LOCAL SCHEME RESERVES		ZONES		OTHER		SCHEME BOUNDARY	
	PUBLIC PURPOSES		RESIDENTIAL		GENERAL INDUSTRY		R CODES		SCHEME BOUNDARY
	RAILWAYS		COMMERCIAL		INDUSTRIAL DEVELOPMENT		ADDITIONAL USES		LOCAL GOVERNMENT BOUNDARY
	PUBLIC OPEN SPACE		SPECIAL USE (SEE SCHEME TEXT)		RURAL		SPECIAL CONTROL AREA - INFRASTRUCTURE		TOWNSITE - LAND ACT
	PRIMARY DISTRIBUTOR ROAD		URBAN DEVELOPMENT		RURAL RESIDENTIAL (SEE SCHEME TEXT)				
	LOCAL ROAD		ENTERPRISE		RURAL SMALLHOLDINGS				

Authorised :
 Plot Date:
 G.Gazette:

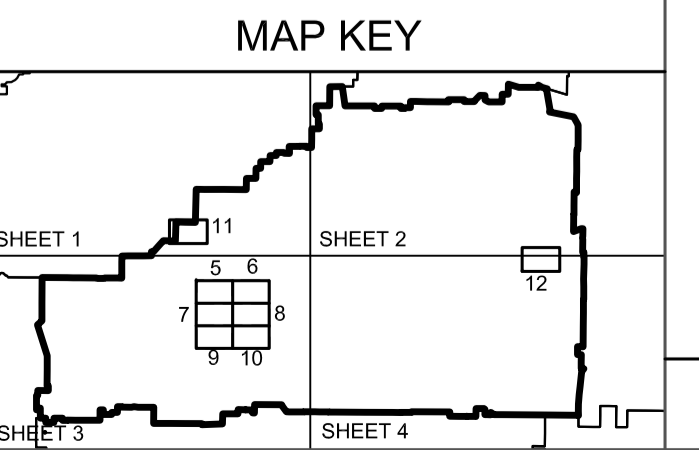
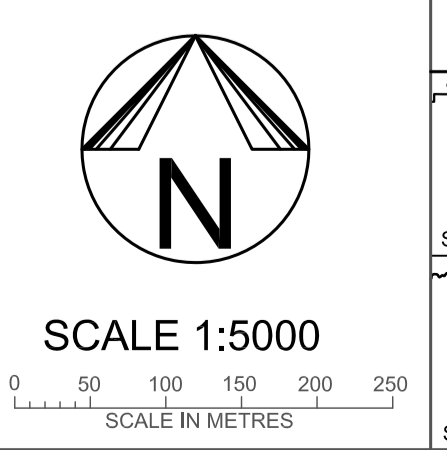

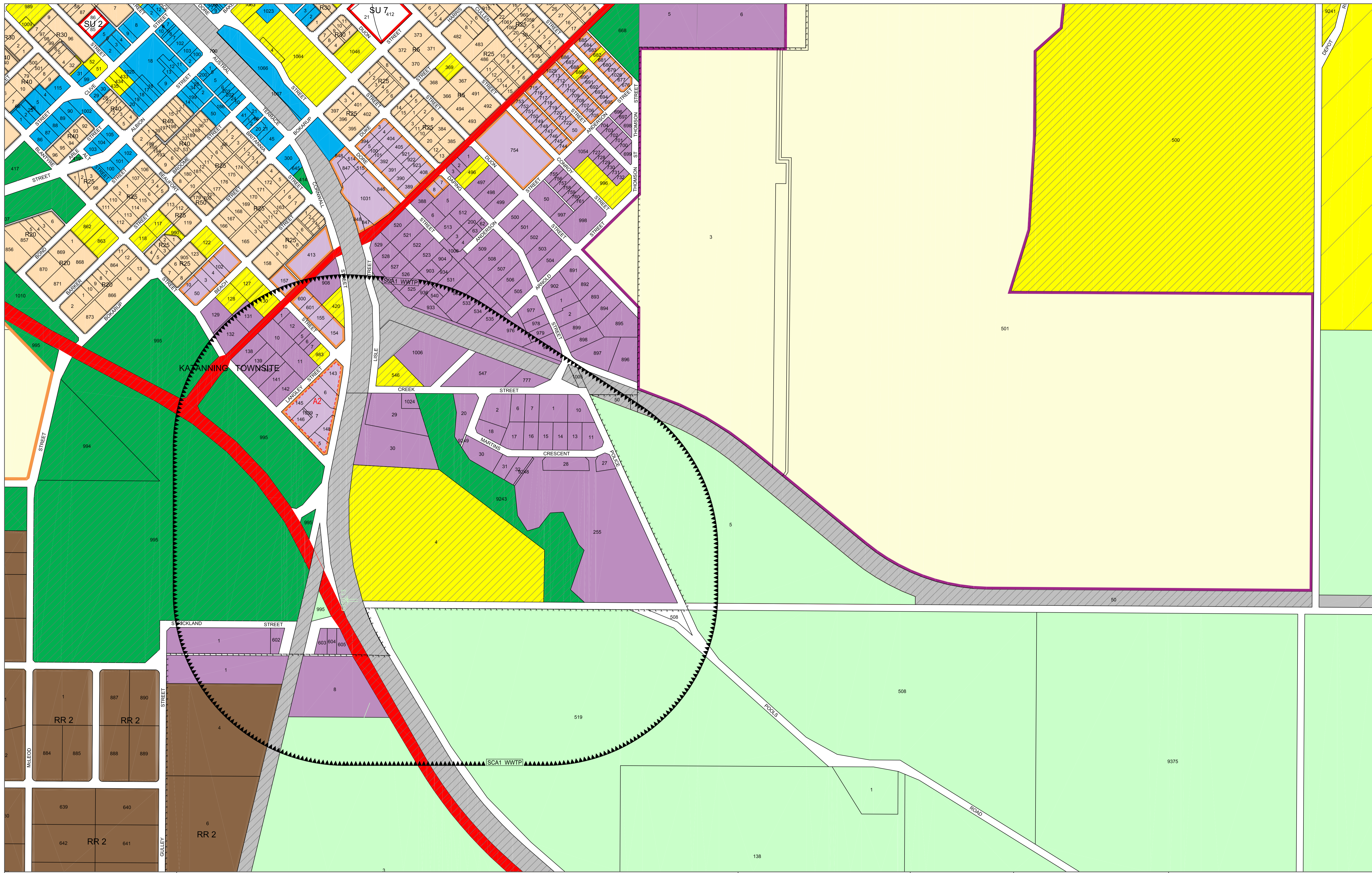

Produced by the planning department of the Shire of Katanning, Drafting by John de Snoo

Whilst every care has been taken to accurately portray the current Scheme provisions, no responsibility shall be taken for any errors or omissions in this documentation.

Consultation with the Shire of Katanning should be made to view a legal version of the Scheme. Please advise the Department of Planning of any errors or omissions in this document.

Base on cadastral data supplied by Landgate.

LEGEND

LOCAL SCHEME RESERVES

- PUBLIC PURPOSES
- RAILWAYS
- PUBLIC OPEN SPACE
- PRIMARY DISTRIBUTOR ROAD
- LOCAL ROAD

ZONES

- RESIDENTIAL
- COMMERCIAL
- SPECIAL USE (SEE SCHEME TEXT)
- URBAN DEVELOPMENT
- ENTERPRISE

OTHER

- GENERAL INDUSTRY
- INDUSTRIAL DEVELOPMENT
- RURAL
- RURAL RESIDENTIAL (SEE SCHEME TEXT)
- RURAL SMALLHOLDINGS

R CODES

- R 30
- A 1 ADDITIONAL USES
- SCA SPECIAL CONTROL AREA - INFRASTRUCTURE

SCHEME BOUNDARY

- SCHEME BOUNDARY
- LOCAL GOVERNMENT BOUNDARY
- TOWNSITE - LAND ACT

Authorised :

Plot Date:

G.Gazette:

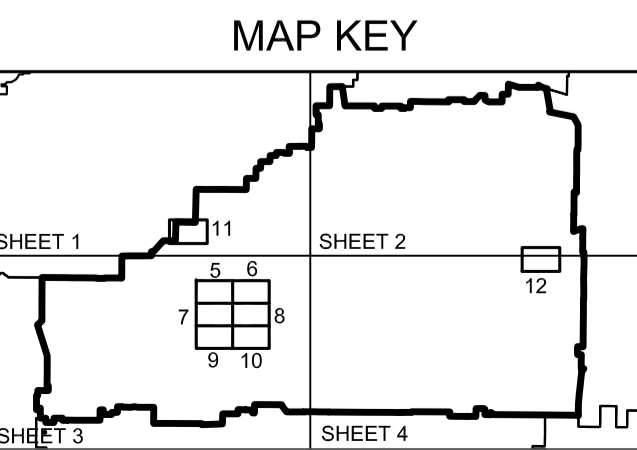
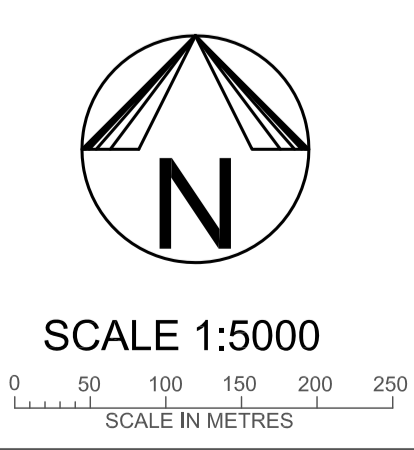

SHIRE OF KATANNING

LOCAL PLANNING SCHEME No. 5

DISTRICT SCHEME

SHEET 10 of 12

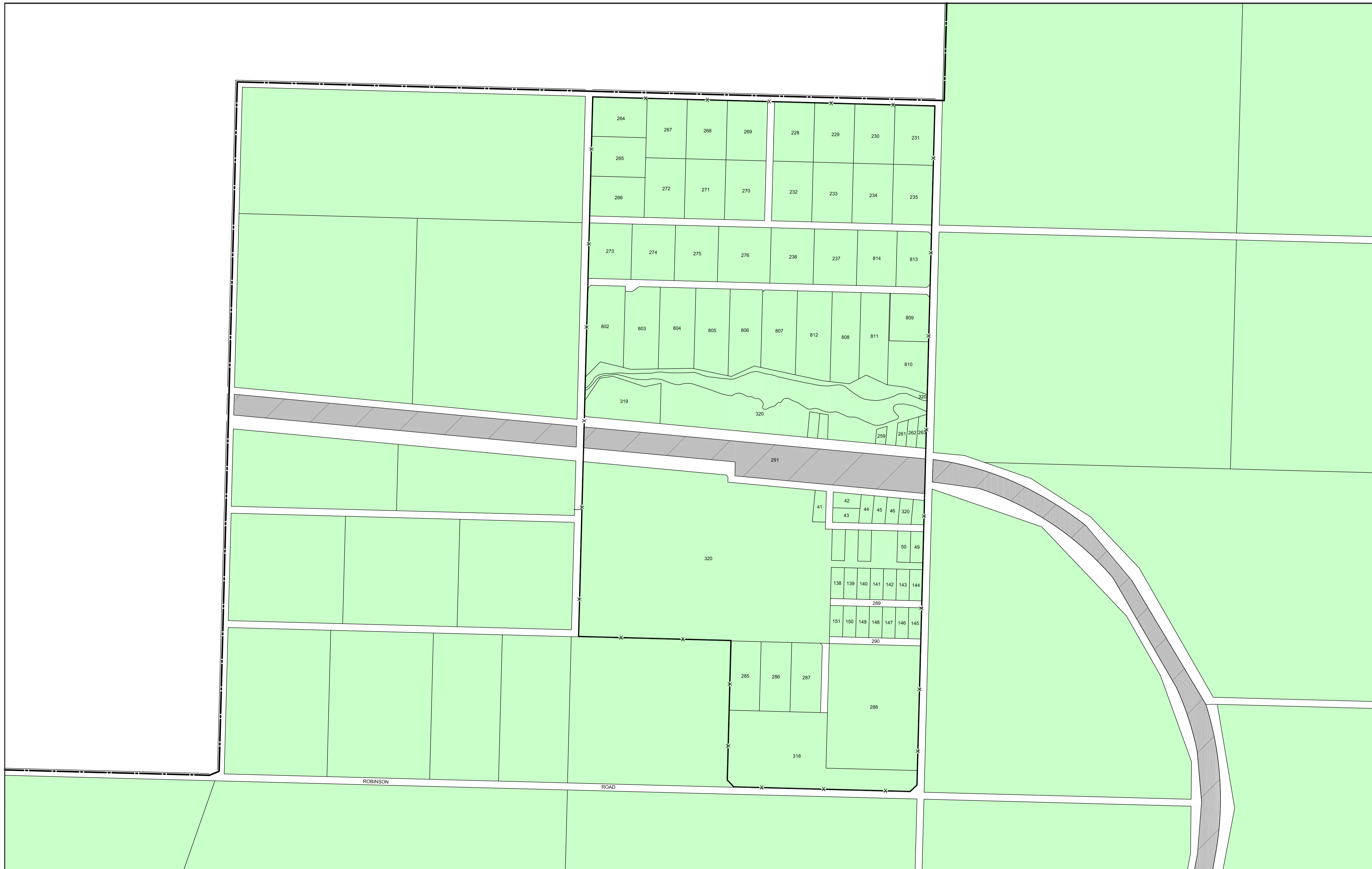

Produced by the planning department of the Shire of Katanning.
 Drafting by John de Snoo

Whilst every care has been taken to accurately portray the current Scheme provisions, no responsibility shall be taken for any errors or omissions in this documentation.

Consultation with the Shire of Katanning should be made to view a legal version of the Scheme.
 Please advise the Department of Planning of any errors or omissions in this document.

Base on cadastral data supplied by Landgate.

LEGEND

LOCAL SCHEME RESERVES	ZONES	GENERAL INDUSTRY	OTHER	SCHEME BOUNDARY
PUBLIC PURPOSES	RESIDENTIAL	INDUSTRIAL DEVELOPMENT	R CODES	LOCAL GOVERNMENT BOUNDARY
RAILWAYS	COMMERCIAL	RURAL	ADDITIONAL USES	TOWNSITE - LAND ACT
PUBLIC OPEN SPACE	SPECIAL USE (SEE SCHEME TEXT)	RURAL RESIDENTIAL (SEE SCHEME TEXT)	SPECIAL CONTROL AREA - INFRASTRUCTURE	
PRIMARY DISTRIBUTOR ROAD	URBAN DEVELOPMENT	RURAL SMALLHOLDINGS		
LOCAL ROAD	ENTERPRISE			

Authorised :
 Plot Date:
 G.Gazette:

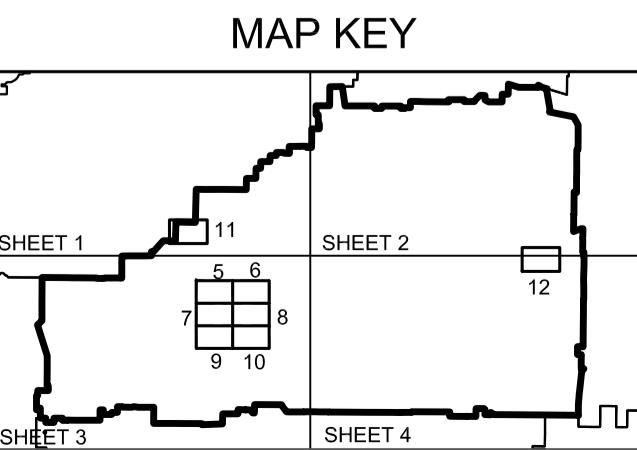
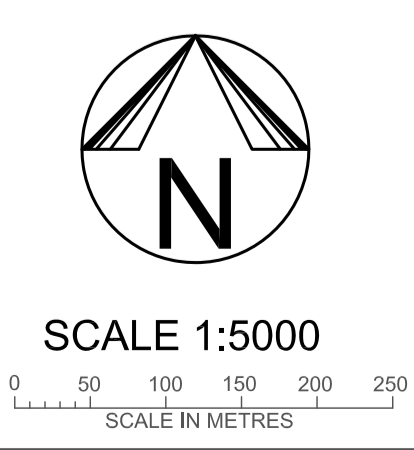

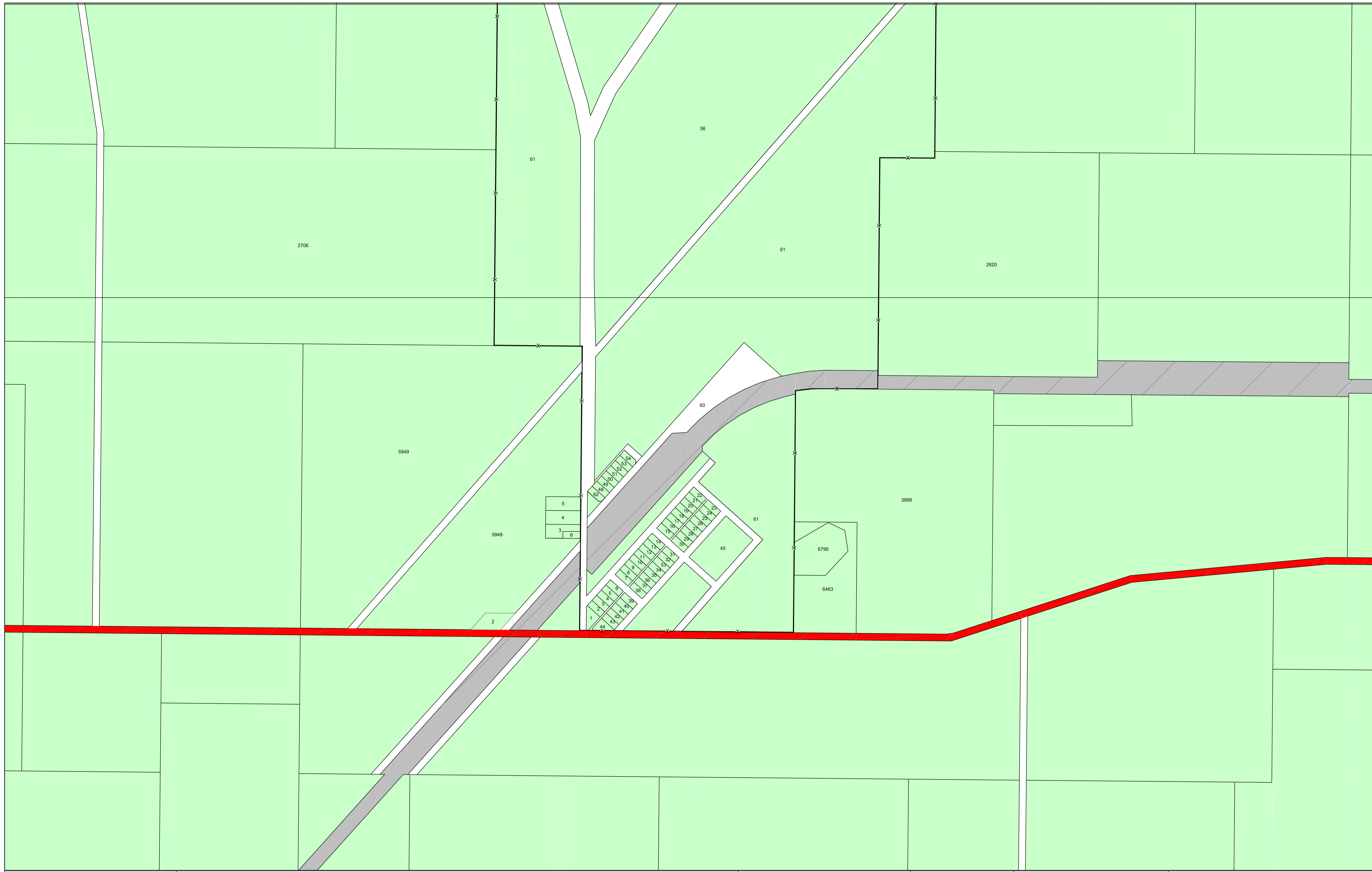

Produced by the planning department of the Shire of Katanning.
 Drafting by John de Snoo

Whilst every care has been taken to accurately portray the current Scheme provisions, no responsibility shall be taken for any errors or omissions in this documentation.

Consultation with the Shire of Katanning should be made to view a legal version of the Scheme.
 Please advise the Department of Planning of any errors or omissions in this document.

Base on cadastral data supplied by Landgate.

LEGEND		ZONES		OTHER			
PUBLIC PURPOSES	RESIDENTIAL	GENERAL INDUSTRY	R 30	R CODES	SCHEME BOUNDARY		
RAILWAYS	COMMERCIAL	INDUSTRIAL DEVELOPMENT	A1	ADDITIONAL USES	LOCAL GOVERNMENT BOUNDARY		
PUBLIC OPEN SPACE	SU 1	RURAL	SCA	SPECIAL CONTROL AREA - INFRASTRUCTURE	TOWNSITE - LAND ACT		
PRIMARY DISTRIBUTOR ROAD	URBAN DEVELOPMENT	RR 1					
LOCAL ROAD	ENTERPRISE	RURAL SMALLHOLDINGS					

Authorised :
 Plot Date:
 G.Gazette:

